

# AT-03 Technical Specifications



## Features:

- 4.0 GPM @ 45PSI
- 1.5 GPM Flowrate on Handshower
- Seperate handheld shower wand
- European Ceramic Cartridges
- Rough In Box Included

## Code Compliance:

- IAPMO UPC Certified
- ASME A112.18.1
- CEC Compliant
- ASME A112.18.3 (Backflow Prevention)

## Colors:



## Finish:

Polished Chrome | Brushed Steel

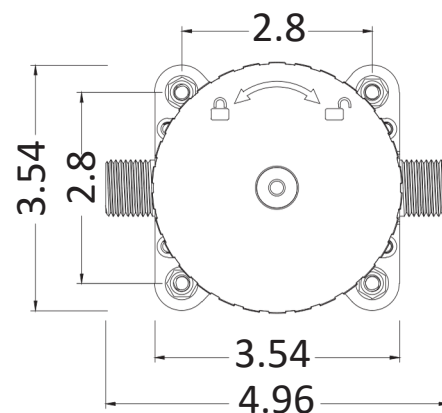
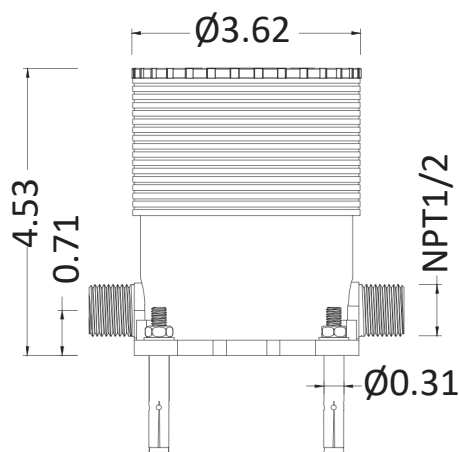

# AT-03 Technical Specifications

